

# ATTACHABLE 3-POLE

## Attachable Portable Plugs and Receptacles, 3 Pole. R65 and R68 Series

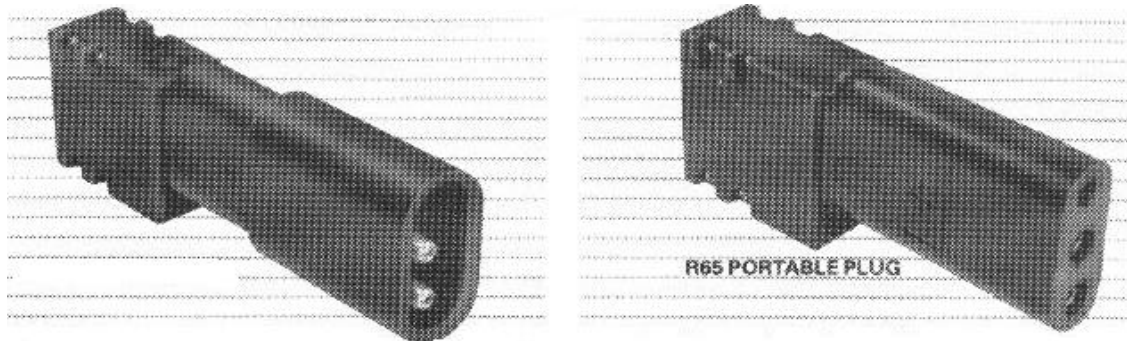

The ATTACHABLE Portable Plugs and Receptacles are molded of Hypalon\*, a compound specially selected for its resistance to moisture and chemicals as well as its ability to stand up under severe wear and tear. Power contacts are of machined copper, silver-plated to reduce contact resistance. Contact lugs may be either crimped or soldered to cables. The R65 and R68 series are manufactured to MS25488 specifications. Portable receptacles are particularly useful where a portable connection is required or for extending existing cable assemblies. \*du Pont

### ORDERING INFORMATION

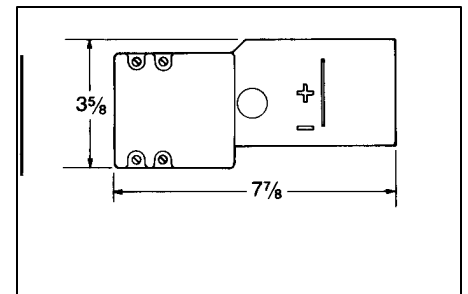
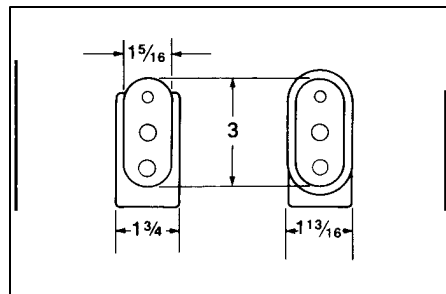
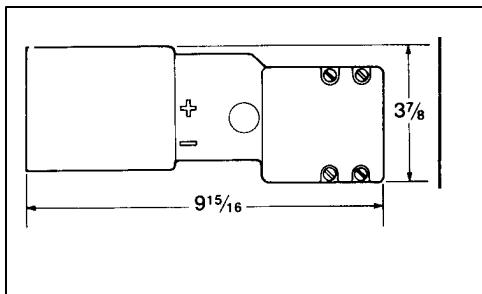

Schematic	Catalog No. Portable Plug	Cable Accommodation (All MIL-C-5756 Type Cables)	Catalog No. Portable Receptacle
	R65G1B, E	Two #1/0 Single Conductor	R68G1B
	R65G2B, E	Two #2/0 Single Conductor	R68G2B
	R65G3B, E	Two #4/0 Single Conductor	R68G3B
	R65G4B, E	#1/0 Twin Conductor, Oval	R68G4B
	R65~5B, E	#2/0 Twin Conductor, Oval	R68G5B
	R65G6B, E	#4/0 Twin Conductor, Oval	R68G6B
	R65G7B, E	Two #2 Single Conductor	R68G7B
	R65G8E	#1/0 Welding Single Conductor	
	R65G9E	#2/0 Welding Single Conductor	

All dimensions are in inches and for reference only; they should not be used for layout work. Specific details will be furnished on request.

# ATTACHABLE™ 3-POLE

## Attachable Portable Plugs and Receptacles R64 and R71 series

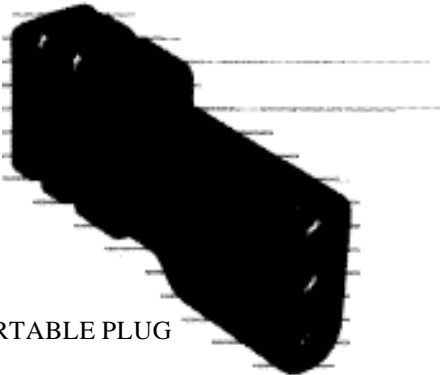

R64 PORTABLE PLUG

### ORDERING INFORMATION

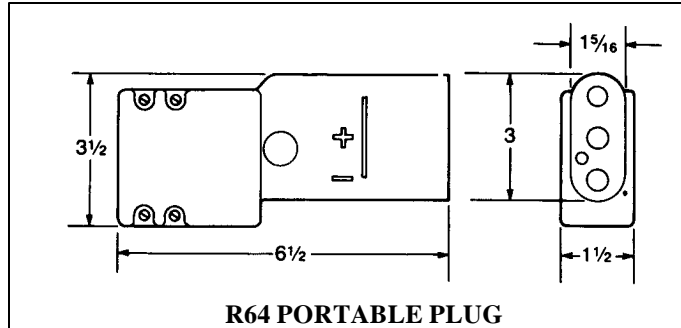

The R64 Series are manufactured to MS25488 Specifications

Schematic	Catalog No. Portable Plug	Cable Accommodation (All MIL-C-5756 Type Cables)
	R64G1B	Two #2/0 and One #12 Conductors Under single Oval Sheath
	R64G28	Two #4/0 and One #12 Conductors Under single Oval Sheath
	R64G3B	Two #1/0 and One #12 Conductors Under single Oval Sheath



R71 PORTABLE PLUG

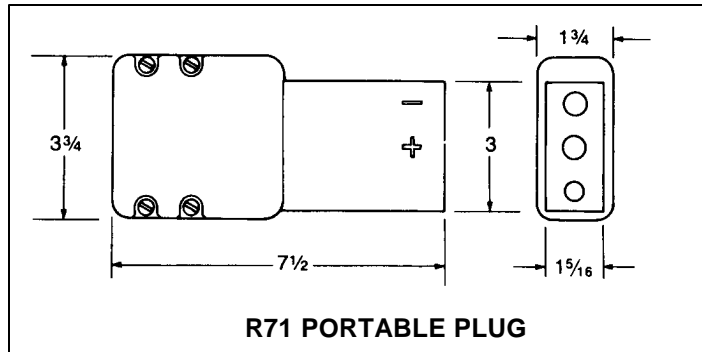

Schematic	Catalog No. Portable Plug	Cable Accommodation (All MIL-C-5756 Type Cables)
	R71G3B, E	Two #4/0 Single Conductor and One #12 Twin Conductor
	R71G4B, E R71 G6B, E	Two #4/0 and One #12 Conductors Under Single Oval Sheath Two #4/0 Single Conductor and One #8 Single Conductor
	R71G5B, E (WITH OVAL FRONT)	Two #4/0 Single Conductor and One #10 Twin Conductor

The R71 Series are manufactured to MS25487 Specifications. R71G5B has oval front to fit 4621B fixed receptacle.

# R765

## 28 Volt DC - Four Wire ATTACHABLE®

- *Extra quick & easy assembly*
- *Lower Power Loss*

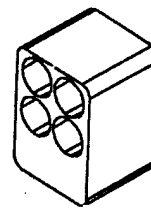

SEALING  
GROMMET

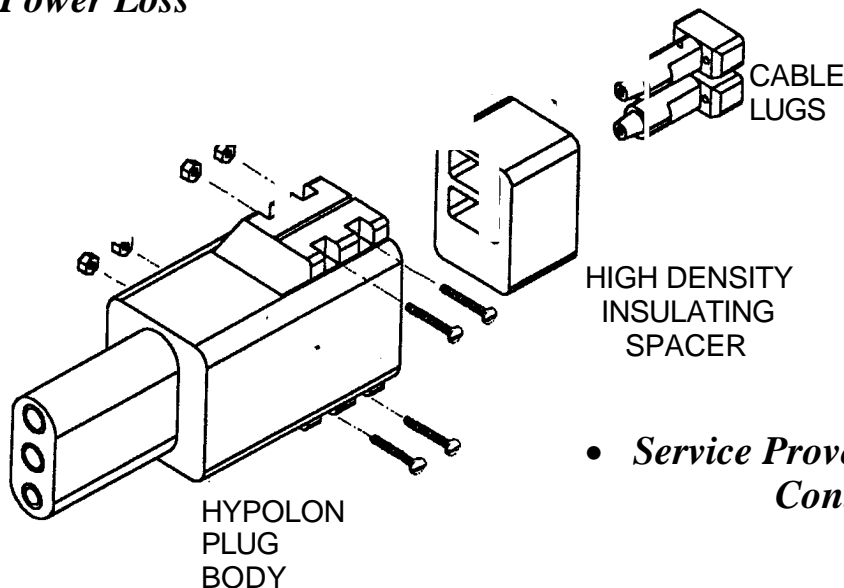

- *Service Proven Replaceable Grabber Contact design*

**Make new or repair cable assemblies with the new R765 DC ATTACHABLE PLUG**

### SAFETY FEATURES

- Fingerproof insulators (per ISO stds) prevent accidental touching of contacts
- Extra insulation for greater internal hi-pot resistance
- Double sealed molded in contacts assure water tight assembly

### DURABILITY AND RELIABILITY FEATURES

- Now make DC Cable assemblies with four (4) wire configuration for lowest power loss.
- Straightforward quick and easy assembly for fast cable repair turnaround.
- Crimp or solder cable onto lugs
- Grabber Contact system has self-aligning contacts that compensate for part to part variations and movement caused by structural loading.

***ANDERSON AIRMOTIVE PRODUCTS Co., Inc.***